

### Features

- 1/8 to 3/8 tube OD
- Electroless nickel plated brass and 316 stainless steel
- Several sizes and configurations
- Swivel elbows and tees
- Metal release buttons
- O-ring seal (10-32 UNF fittings only)



## Pneumadyne's Push-to-Connect Fittings

Pneumadyne's new Push-to-Connect fittings enable quick tubing connection and disconnection. A variety of male and female connectors, elbows and tees feature tube ODs ranging from 1/8 to 3/8 and 10-32, 1/8 NPT or 1/4 NPT threads. To ensure a leakproof fit, thread sealant is standard on all male pipe threads and the 10-32 UNF thread features an o-ring for a superior seal.

The 316L stainless steel fittings are suitable for applications in corrosive environments where brass and Acetal are typically prohibited. FPM seals ensure that these fittings can also withstand high temperatures (working temperature is dependent upon tubing).

Tubing connection and tightness are made possible by the presence of a stainless steel gripping collet and an O-ring inside the fitting. Once the

tube is inserted to the bottom of the fitting, the stainless steel collet grips the tube and prevents it from being released. The tubing is disconnected by simply pushing the metal release button and removing the tube from the fitting.

### Materials

Brass: Electroless Nickel Plated Brass, Acetal Resin, Stainless Steel, NBR

Stainless Steel: 316L Stainless Steel, 301 Stainless Steel, FPM/FKM

### Tubing Recommendation Chart

Fitting Material	Tubing Material
Brass	95A Durometer Polyurethane
Stainless Steel	PTFE, PVDF

***Pneumadyne's Stainless Steel Fittings are suitable for use in industries such as:***

- ***Food & Beverage***
- ***Medical & Dental***
- ***Semi-Conductor***
- ***Pharmaceutical***
- ***Agriculture***
- ***Chemical processing***

## PUSH-TO-CONNECT FITTINGS



For limited space applications, the male straight connector features an inner hex allowing for easy installation.



Multiple configurations ease fitting installation.

### Product Number Diagram

*Push-to-Connect Fittings*

**P B 1 5 6 - 1 / 8 - 3 1 6**

#### Fitting Configuration

PB= Male Connector  
PFB= Female Connector  
PFLS= EL Female  
PLS=EL Swivel  
PTS= Tee Swivel  
PT= Union Tee  
PY= Union Y

#### Tube OD

125= 1/8  
156= 5/32  
250= 1/4  
312= 5/16  
375= 3/8

#### Thread Size

1032= 10-32 UNF  
1/8= 1/8 NPT  
1/4= 1/4 NPT

#### Suffix

316= Stainless Steel

Please use Part Number Listing to verify part number- not all configurations are possible

### Ordering Information

- To order standard product use part number listing.
- For 316 Stainless Steel add a -316 suffix to the part number.
- Standard package quantities:  
-5 pcs per bag, Electroless Nickel Brass  
-1 pc per bag, 316L SS

## Straight Connector

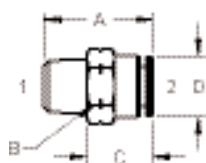

Part Number	A	B Hex	C	D	1	2 Tubing OD
PB125-1032	0.649	5/16	0.453	0.275	10-32 (M)	1/8
PB125-1/8	0.728	7/16	0.394	0.275	1/8 (M)	1/8
PB156-1032	0.767	3/8	0.571	0.354	10-32 (M)	5/32
PB156-1/8	0.748	7/16	0.414	0.354	1/8 (M)	5/32
PB250-1032	0.925	3/32	.728	.472	10-32 (M)	1/4
PB250-1/8	0.846	1/2	0.512	0.472	1/8 (M)	1/4
PB375-1/8	1.082	11/16	0.748	0.629	1/8 (M)	3/8

## Straight Connector

Female

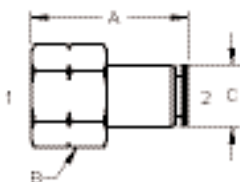

Part Number	A	B Hex	C	D	1	2 Tubing OD
PFB156-1/8	0.964	9/16	0.354		1/8 (F)	5/32
PFB250-1/8	1.043	9/16	0.472		1/8 (F)	1/4
PFB250-1/4	1.220	11/16	0.472		1/4 (F)	1/4

## Elbow Fixed

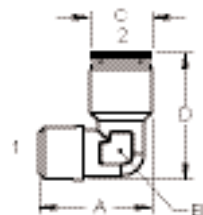

Part Number	A	B Flats	C	D	1	2 Tubing OD
PLB156-1/8	0.787	0.314	0.354	0.877	1/8 (M)	5/32
PLB250-1/8	0.865	0.393	0.472	0.995	1/8 (M)	1/4
PLB312-1/8	0.945	0.472	0.551	1.054	1/8 (M)	5/16

## Elbow Swivel

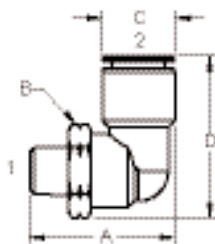

Part Number	A	B Hex	C	D	1	2 Tubing OD
PLS125-1/8	0.866	7/16	0.275	0.823	1/8 (M)	1/8
PLS156-1032	0.826	3/8	0.354	0.886	10-32 (M)	5/32
PLS156-1/8	0.905	7/16	0.354	0.922	1/8 (M)	5/32
PLS250-1/8	1.062	1/2	0.472	1.135	1/8 (M)	1/4
PLS375-1/8	1.259	11/16	0.629	1.381	1/8 (M)	3/8

When design makes a dimension critical- contact factory for confirmation. All dimensions are in inches, unless otherwise specified and are subject to change without notice.

Part Number	A	B Hex	C	D	1	2 Tubing OD
PFLS156-1/8	0.944	9/16	0.354	1.073	1/8 (F)	5/32
PFLS250-1/8	1.003	9/16	0.472	1.171	1/8 (F)	1/4
PFLS312-1/8	1.043	9/16	0.551	1.191	1/8 (F)	5/16

## Elbow Swivel

Female



Part Number	A	B Hex	C	D	1	2,3 Tubing OD
PTS156-1/8	1.003	1/2	0.354	1.496	1/8 (M)	5/32
PTS250-1/8	1.062	1/2	0.472	1.692	1/8 (M)	1/4

## Tee Swivel

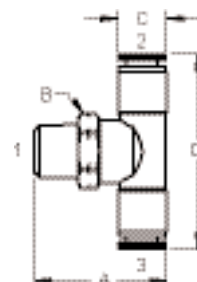

Part Number	A	B	C	1, 2, 3 Tubing OD
PT156	0.846	0.354	1.338	5/32
PT250	1.023	0.472	1.574	1/4
PT312	1.122	0.551	1.692	5/16

## Tee Union

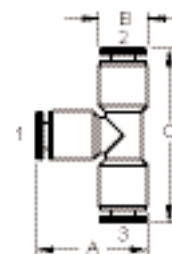

Part Number	A	B	C	1, 2, 3 Tubing OD
PY156	1.122	0.354	0.728	5/32

## Union Y

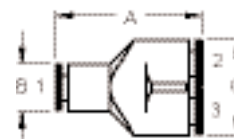

When design makes a dimension critical- contact factory for confirmation. All dimensions are in inches, unless otherwise specified and are subject to change without notice.

## Straight Connector

## 316L Stainless Steel

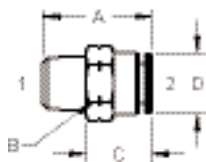

Part Number	A	B Hex (mm)	C	D	1	2 Tubing OD
PB156-1/8-316	0.748	11	0.414	0.354	1/8 (M)	5/32
PB250-1/8-316	0.846	13	0.512	0.472	1/8 (M)	1/4

## Elbow Swivel

## 316L Stainless Steel

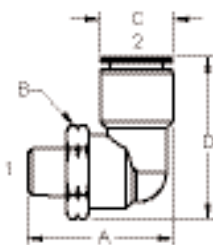

Part Number	A	B Hex (mm)	C	D	1	2 Tubing OD
PLS156-1/8-316	0.905	11	0.354	0.922	1/8 (M)	5/32
PLS250-1/8-316	1.062	13	0.472	1.135	1/8 (M)	1/4

## Tee Swivel

## 316L Stainless Steel

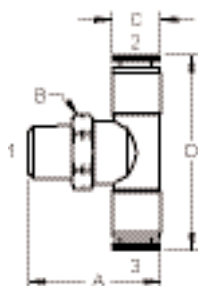

Part Number	A	B Hex (mm)	C	D	1	2, 3 Tubing OD
PTS156-1/8-316	1.003	11	0.354	1.496	1/8 (M)	5/32
PTS250-1/8-316	1.062	13	0.472	1.692	1/8 (M)	1/4

## Tee Union

## 316L Stainless Steel

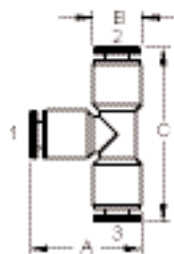

Part Number	A	B	C	1, 2, 3 Tubing OD
PT156-316	0.846	0.354	1.338	5/32
PT250-316	1.023	0.472	1.574	1/4
PT312-316	1.122	0.551	1.692	5/16

When design makes a dimension critical- contact factory for confirmation. All dimensions are in inches, unless otherwise specified and are subject to change without notice.

**FPM seals withstand high temperatures- SS Fittings only**  
(working temperature is dependent upon tubing)



### Features

- Push-to-connect
- Precision machined
- Acetal release button
- Captured o-ring seal
- Electroless Nickel plated

Push-to-Connect style fittings ease tubing connection and disconnection without the use of tools. Recommended for use with 95A Durometer Polyurethane tubing, these precision machined fittings are Electroless nickel plated for corrosion resistance. Red Acetal release buttons are standard, contact factory for optional colors.

## Push-to-Connect Straight Connector Fittings

Part Number	A	B Diam.	C	D Diam.	1	2 Tube OD
SF-125PI	.88	.32	.72	.38	10-32 (M)	1/8
SF-156PI	.88	.32	.72	.38	10-32 (M)	5/32

### Push-to-Connect

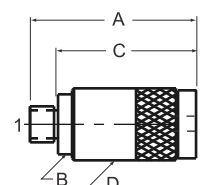

### Materials

Brass, Electroless Nickel Plating, Acetal, Buna-N Seals

### Ordering Information

- Standard quantities
  - 25 pcs per bag
  - 100 pcs per box
- Red release button standard; contact factory for optional colors
- 95A Durometer Polyurethane recommended
- Cavity drawing available for **full** cartridge- contact factory
- **Half** cartridge is available for direct installation- contact factory